



SD⁺ 302-22



The newest and highest performance version in the venerable SD range is the SD Plus. New, upgraded hardware and software include a high accuracy digital sensor and integrated data logger. All climate data can be tracked and recorded over time through an Ethernet connection and included software.

The integrated data logger can provide all climate data and door openings from the cabinet through Ethernet and free available software, for further analysis.

The circulation of air in the cabinet is regulated through an integrated fan.

All surfaces are ESD coated in conformity with current ESD 61340-5-1 standard.

The SD⁺ 302-22 is ideal for the moisture-proof and anti-oxidation storage of wide-ranging technologies and conforms with IPC/JEDEC J- STD 033C & IPC-1601.





Features

- **Online functionality**
- **Accurate sensor RH% and T°C**
- **Lockable doors**
- **ESD safe design**
- **Door & humidity alarm buzzer**
- **Shelves**
- **Dry unit**
- **Power supply**
- **2-series digital display**
- **Castors**
- **Option availability**
- **ESD bonding point**
- **Display multilanguage**
- Interface and datalogging through standard Ethernet interface
- Compatible with new MSL 2.0 software
- +/- 0,8 % RH, +/- 0,1 °C
- 2 doors locked with key.
- Norm (IEC 61340-5-1)
ESD metal painted body (10⁶ Ohm/sq)
Dissipative glazing (in- and outside 10⁸ Ohm/sq)
- Longer door openings are detected, high RH levels are detected
- 7 in height adjustable ESD painted steel shelves
- U-2000 dry unit
- Cable 5 meter with IEC plug
- Very convenient settings of RH%, and alarm functions. (3 color)
- 360° rotating wheels
- N₂ Auto Flow, Heating, SMD Reel Racks, etc.
- ESD wristband can be connected to the cabinet
- Display can be set to English & German.

Benefits

- **Maintenance**
- **Recoverytime after dooropening**
- **Adjustable legs**
- **Temperature**
- **IPC**
- **Energy saving**
- **Remote access**
- **Sensor calibration**
- **More stable Humidity & Temperature**
- The drying unit is maintenance free, easy to service
- <15 min to below 1% with 1 dry unit. (by 1 door opening)
- For leveling out (optional)
- Maximal up to 40 °C (optional)
- According to IPC/JEDEC J- STD 033C & IPC-1601
- Lower power consumption through dynamic regeneration
- Remote access for easy long distance service purposes
- Yearly sensor calibration program for ISO standards
- Dynamic regeneration ensures a more stable climate





Technical Data Cabinet

- External dimensions: (W x H x D) 500 x 1277 x 640 mm
- Internal dimensions: (W x H x D) 490 x 1124 x 602(594) mm
- Weight: 68 kg
- Weight on shelf: 30 kg
- Max. loading capacity: 100 kg
- Body: Steel, conductive coated 10⁸ Ω/sq
- Shelves (W x D): 4 pcs long, 468 x 510 mm adjustable.
3 pcs short, 468 x 468 mm adjustable.
- Volume: 320 L
- Voltage: 230 VAC (120 VAC optional)
- Protection class: hard grounded, Class 1
- Humidity level cabinet: Drying ≤1% RH *

*(depending on amount of door openings)

Technical Data Dry Unit U-2000

- Control: Adjustable with control panel 2-series
- Voltage level: 230 VAC/50 Hz. (optional 120 VAC/60 Hz)
- Power consumption: 350 W
- Dimensions: W x H x D = 260 mm x 380 mm x 100 mm
- Weight: 8,1 kg.

Technical Data 2-series Display

Settings:

- Language Menu
- Setpoint Humidity
- Limit Humidity Alarm
- Humidity Alarm Delay
- Doors Alarm
- Interlocking
- Manual Regeneration

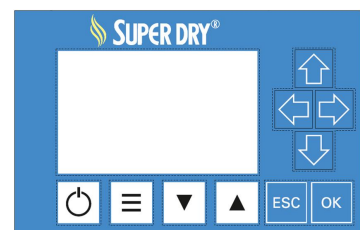

Display:

- Supply voltage 24 VAC/DC
- Input 4 function keys (tactile-touch keys)
- Display 61 x 33 mm, multicolor, controllable backlight, adjustable contrast
- Ethernet connection
- Power consumption at 24 VDC, 40 mA





Technical Data Rotronic Sensor HC2-S

Based on the Airchip 3000 Technology use, the HygroClip 2 probes can be used for control of temperature and humidity.

The HygroClip 2 probes can be configured with the ROTRONIC HW4 software and share the following features:

- Measurement of relative humidity.
- Data recording of up to 2000 relative humidity and temperature value pairs.
- Programmable automatic sensor test with fail safe mode and sensor drift compensation.



Technical Data N₂ Auto Flow

- Power supply: 230 VAC (110 VAC optional)
- N₂ Connection: 8 mm hose connection
- N₂ Pressure: 1 – 6 bar
- N₂ Standby- amount: 0 – 25 L/min
- N₂ Purge: 0 – 25 L/min

Technical Data Heater SH 230-1

- Voltage: 230 VAC (110 VAC optional)
- Frequency AC: 50/60 Hz
- Power: 530 W
- Temperature sensor: PTC 100
- Thermal protection: 90 °C
- Temperature range: 30 – 40 °C
- Air Flow: 86 M³/H
- Display tolerance: 1 digit at 25 °C





Performance

Test conditions

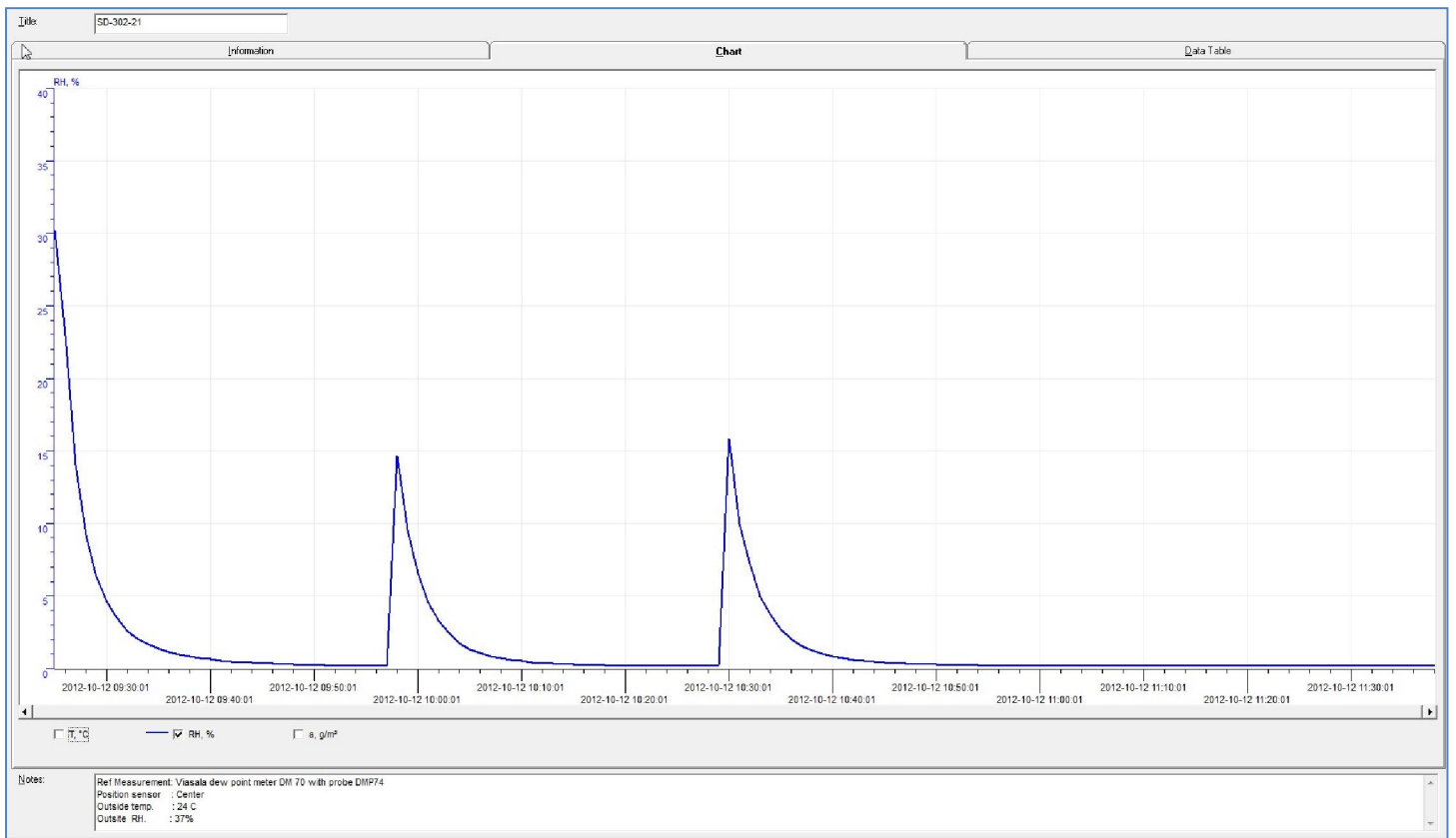

Instrument:
Type of dew point sensor:
Accuracy of dew point sensor:
Location of sensor:
Ambient conditions:
Dooropenings:

Vaisala.
Vaisala drycap 180M
 $\pm 0,2^{\circ} \text{C}$ at $+ 20^{\circ} \text{C}$ ($+ 68^{\circ} \text{F}$)
In the direct surrounding of cabinet sensor
Humidity $50 \pm 5\% \text{ rH}$, $25^{\circ} \pm 2^{\circ} \text{C}$, Pressure $994 \pm 20 \text{ hPa}$.
2 dooropenings, 15 sec. (average RH 0,70%)





Technical Drawings

SD+ 302-22

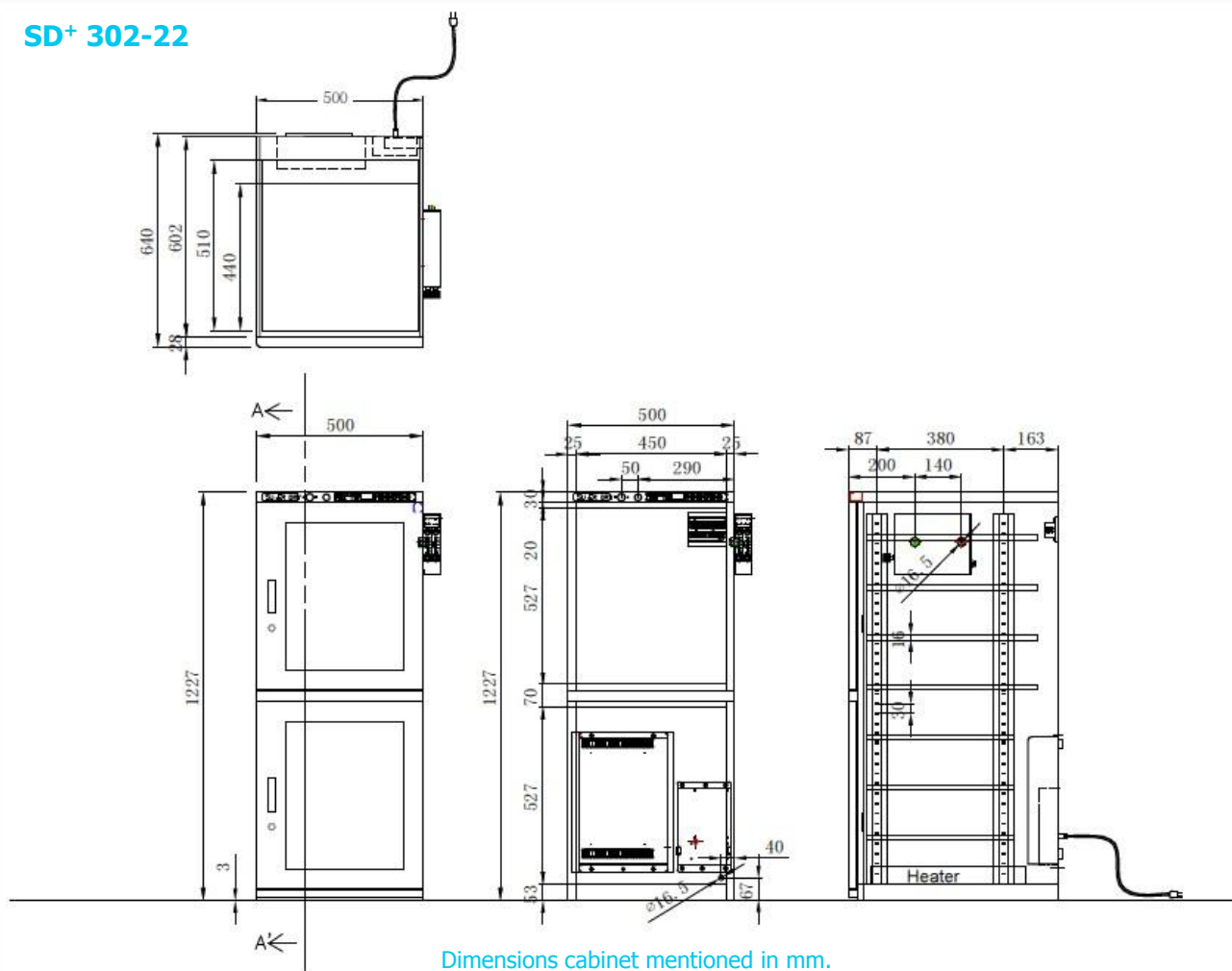

Number of shelves top section	1	2	3	4
Distance (in mm) between shelves if equally divided (if bottom shelf is mounted on the lowest possible position in the section)	x	250	160	125
Remaining space between top shelf and top beam	495	245	160	105
Remaining space between bottom shelf and bottom cabinet (if bottom shelf is mounted on the lowest possible position in the section)	0	0	0	0
Loading capacity shelves m ² (468 mm x 510 mm)	0,24	0,48	0,71	0,95
Number of shelves bottom section	1	2	3	
Distance (in mm) between shelves if equally divided in bottom section	x	165	103	x
Remaining space between top shelf and top beam	295	155	120	x
Remaining space between bottom shelf and bottom cabinet	265	175	145	x
Loading capacity shelves m ² (468 mm x 468 mm)	0,22	0,44	0,66	x
Shelves are adjustable every (mm)	30	30	30	30

Measurements can slightly deviate





Technical Drawings

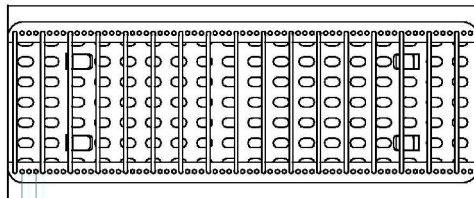
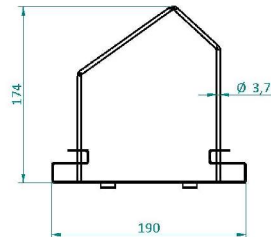
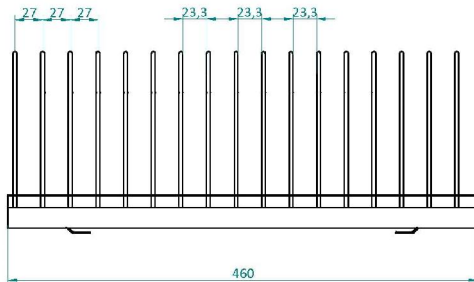

Dimensions of the SMD Reel Rack, item number 20014000



Dimensions of the heater SH 230-1, item number 21001300





Options



SMD Reel Rack

460 mm length
Item number 20014000

SMD Reel supports – reel support for 20014000
Item number 20014200



Shelf

Item number 20015100



Humidity calibrator Hygropalm 22

precision measuring device for calibrating sensors
Set including Hygroclip sensor, case and cable
Item number 20001019

Hygropalm only
Item number 20001016



Rotronic datalogger set

Including Software HW4-E-V3 and Cable AC3006

Item number 47000580



N2 auto flow system

The Auto-Flow-System is developed to use in combination with a Totech drying cabinet. The device is used for the quick removal of moisture in the cabinet after the doors has been opened. The drying process is realized by using nitrogen (N²), which is added automatically after the doors have been closed. (timer controlled)

Item number 22613000



Heater SH 230-1,
40°C heater

Item number 21001300





Options



Humidity alarm signal Lamp

two-color, (orange/green or red/green), magnetically fixed, providing optical signals on operational states and exceeded limit values. Operates on 24 V.

Item number orange/green 20016030



HygroClip 2

Probe with maximum accuracy for all climate measurements

Item number 47000027

Exchange calibrated sensor:

Item number 47000040

Version 02-06



Totech Europe BV

De Linge 28

8253 PJ Dronten

www.superdry-totech.com

Phone: +31 (0) 321 330239

Fax: +31 (0) 321 330254

K.v.K.: Lelystad 390 86417

e-mail: sales@totech.eu

V.A.T. : NL813341887B01

IBAN : NL83Rabo0145683443

BIC : RaboNL2U

Bank : Rabobank 14.56.83.443

