

**A large stack of unpopulated PCB's is placed above the ESD belt conveyor. Unique separation cams take one PCB from the bottom of the stack and lowers it onto the ESD belt conveyor.**



### Standard features

- Short PCB cycle time.
- Controlled by PLC.
- Thin PCB capability.
- By-pass mode selectable without removing PCB stack.
- Conveyor width adjustment using hand crank.
- Towerlight display for machine status.
- Pre-warning low stack sensor.
- CE certified.

### Technical specifications

Transfer height:	950 mm ± 25 mm*
Colour:	RAL 9002*
Flow direction:	Left to right*
Fixed rail:	Front*
Machine interface:	SMEMA*
Conveyor concept:	ESD belt
Belt speed:	14 m/min.
PCB edge support:	3 mm
Components clearance (by-pass):	Top 30 mm, bottom 30 mm
Power supply:	230 VAC/50 Hz/1 Ph
Power consumption:	150 VA max.
Air supply:	4-6 bar
Air consumption:	5 ltr/min max.
PCB cycle time:	± 10 seconds
PCB thickness capability:	0.6 mm - 4.0 mm
PCB stock capacity:	220 mm
	* or specify

### Options

- Electrical conveyor width adjustment
- Automatic conveyor width adjustment
- Extension 200 mm for convenient stack loading
- Cantilevered input- or output conveyor (length 500 mm)
- Touchscreen display
- Alarm buzzer

Other options available on request

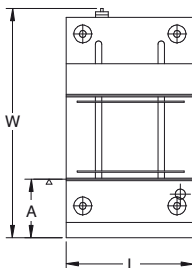

	<b>NTM 220DSM</b>	<b>NTM 220DSL</b>	<b>NTM 220DSXL</b>
Machine dimensions (l x w x h)	500 x 905 x 1300 mm	500 x 905 x 1300 mm	653 x 960 x 1300 mm
Weight	150 kg	150 kg	160 kg
PCB length	80 mm - 457 mm	80 mm - 457 mm	80 mm - 460 mm*
PCB width	50 mm - 250 mm	50 mm - 407 mm	50 mm - 460 mm*
Fixed rail to front dimension (A)	234 mm	234 mm	234 mm

\* or specify